

NDB302-W



KEY FEATURES

- ◆ Simple setup using Wi-Fi
- ◆ Uses existing doorbell wiring
- ◆ 2-Way audio communication
- ◆ HD 1080p live & recorded video resolution
- ◆ Day & night modes with IR upto 15 feet
- ◆ View live and recorded video footage
- ◆ via the free phone App
- ◆ 180° Ultra Wide Angle
- ◆ Noise Suppression and Echo Cancellation
- ◆ Notification and alerts when motion is detected

FEATURES

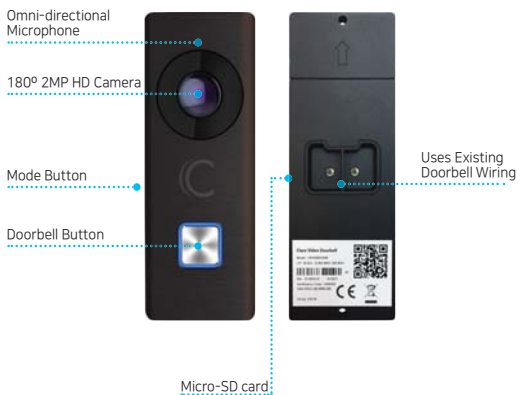

Model	NDB302-W	
System Parameters	Processor	High-Performance embedded SOC Processor
	Operating System	Embedded Linux Operation System
Camera Parameters	Image Sensor	2MP CMOS HD Color Camera
	Light Sensitivity	Low Illumination
	Field of view	180°
Video Parameters	Video compression standard	H.264
	Video streaming	Dual Stream
		Main Stream: 1080p, Sub-Stream: VGA
	Resolution	1920 x 1080
	Wide Dynamic Range	WDR
Audio Parameters	Motion Detection	Yes
	Audio Input	Built-in Omnidirectional Microphone
	Audio Output	Built-in Loudspeaker
	Audio compression standard	G.711 U
	Audio compression rate	64 Kbps
Audio Parameters	Audi quality	Noise Suppression and Echo Cancellation
	Audio Input	Built-in Omnidirectional Microphone
	Audio Output	Built-in Loudspeaker
	Audio compression standard	G.711 U
	Audio compression rate	64 Kbps
Audio Parameters	Audi quality	Noise Suppression and Echo Cancellation
	Infrared	Infrared Distance
		15 Feet
Network Parameters	Network protocol	TCP/IP, RTSP
Device Interfaces	Network interface	1 Wireless Interface (Wireless Network Card)
	Wi-Fi	2.4GHz Wireless N
	MicroSD Card Support	16GB Pre-installed (Support up to 128GB)
General	Power supply	AC 16V ~24V
	Working temperature	-30°C to +50°C (-22°F to 122°F)
	Working humidity	10% to 90%
	IP protection level	IP54
	Reset button	Yes

INSTALLATION

