

SPECIFICATIONS

Parameters	Model	DS-KAB02
Housing material		Stainless Steel SUS201
Inner-shell material		SGCC
Working temperature		-30° C TO +70° C (-22° F to 158° F)
Working humidity		10% to 90%
Dimension (L x W x H)		193mm x 106mm x 80mm (7.60" x 4.17" x 3.15")

DIMENSION

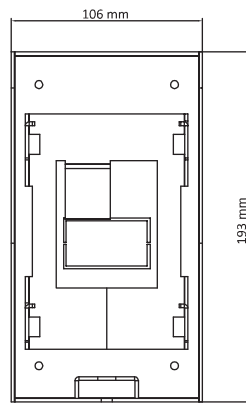

Front View

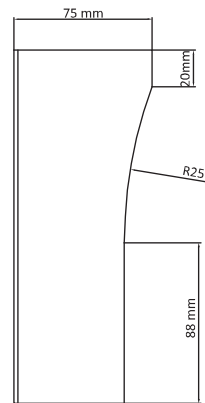

Slide View

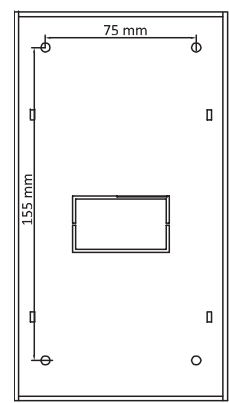

Rear View

FEATURES & NOTES

- ◆ Stainless steel material
- ◆ Convenient design available for the wall mounting of the villa door station (DS-KV8X02-IM) wall mounting
- ◆ No insulation

INSTALLATION

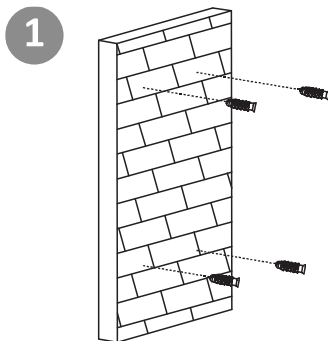

Insert 4 expansion tubes into the wall.

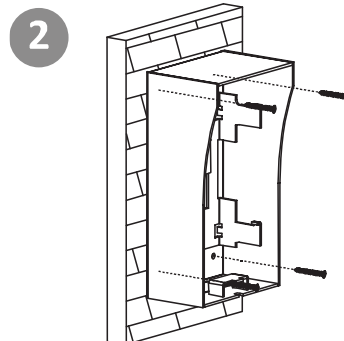

Fix the protective shield on the wall with 4 screws.

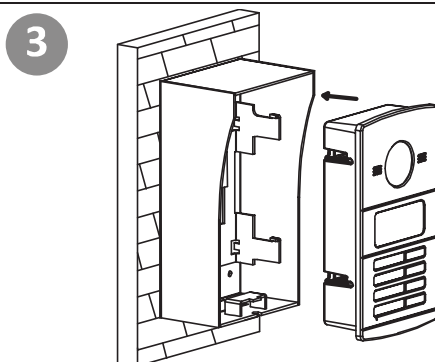

Install the door station into the protective shield .

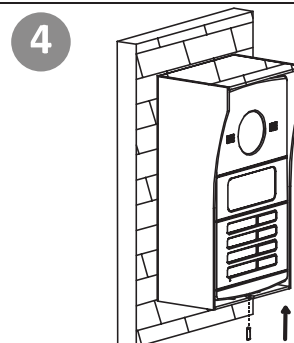

Secure the door station with the shield with a set screw.