

Unpacking

Please make sure the package contains the following items:

Universal Accessories (Please find in device box):

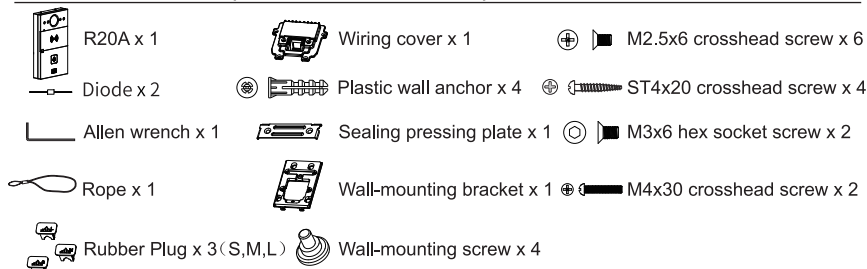

Flush-mounting Accessories :

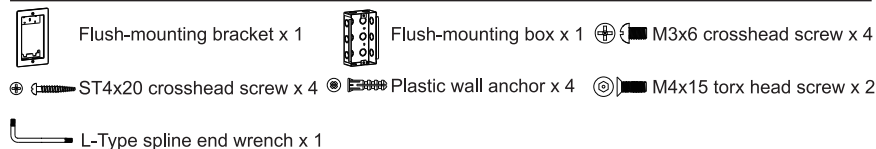

Product Overview

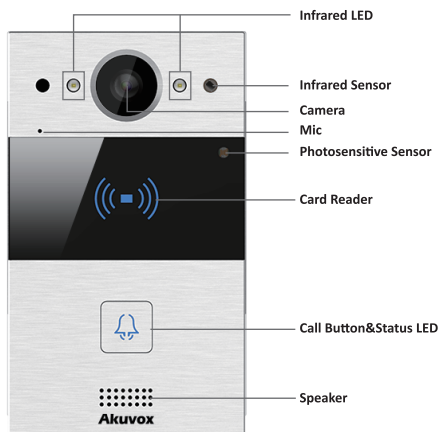

R20A

Installation Environment

Please do not place device under direct sunlight.

If installing the device indoors, please keep device at least 2 meters away from light, and at least 3 meters away from window and door .

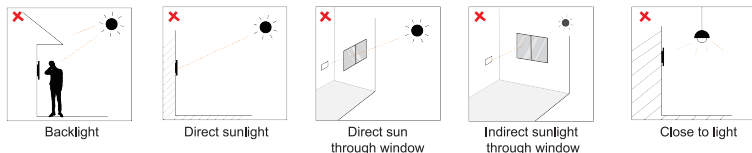

Installation

Step 1: Embedded/Box Installation Flush Mounting

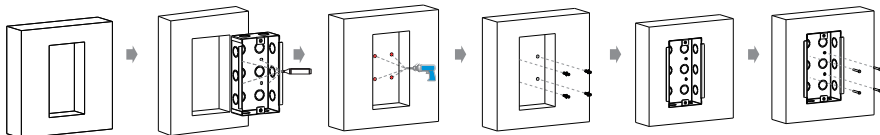

According to the position of the cable, cut a square hole in wall. (height*width*depth=180*101*50 mm). Note: The size of the hole should be a little larger than recommended value that it can accommodate all needed cables.

Insert the embedded box into the hole and make sure the cables of the device can route through the cable hole then mark the four screw holes of the wall embedded box on the wall.

Take down the embedded box then use a 6 mm hand drill to make holes with a depth of 25 mm at the marked positions.

Insert four Plastic wall anchor into the holes.

Place the embedded box into the square hole until the edges of which align to the wall and make all cables go through the cable hole.

Fix the embedded box with four ST4x20 crosshead screw. Then use cement or non-corrosive structural adhesives to fill the gap between the wall and embedded box.

Or you can choose another simple method without fixing ST4x20 crosshead screw



According to the position of the cable cut a square hole in the wall (height*width*depth=180*101*50 mm).

Note: The size of the hole should be a little larger than recommended value that it can accommodate all needed cables.

Use cement or non-corrosive structural adhesives to fill the gap between the wall and embedded box. Wait the adhesive material desiccation, go to the next step.

Waterproof Tips:

- For flush mounting installation, it is recommended to fill the gaps around the embedded box for waterproofing (to prevent water from entering the back cover of the door phone from the gap).
- For wall mounting installation, it is recommended to lock the wall-mounted bracket and the wall so that the EVA pasted on the bottom of the wall mounting bracket is close to the wall without a gap (to prevent water from entering the back cover of the door phone from the gap)
- Or it is recommended to use rain cover.

Step 2: Flush-mounting bracket and Wiring cover Installation

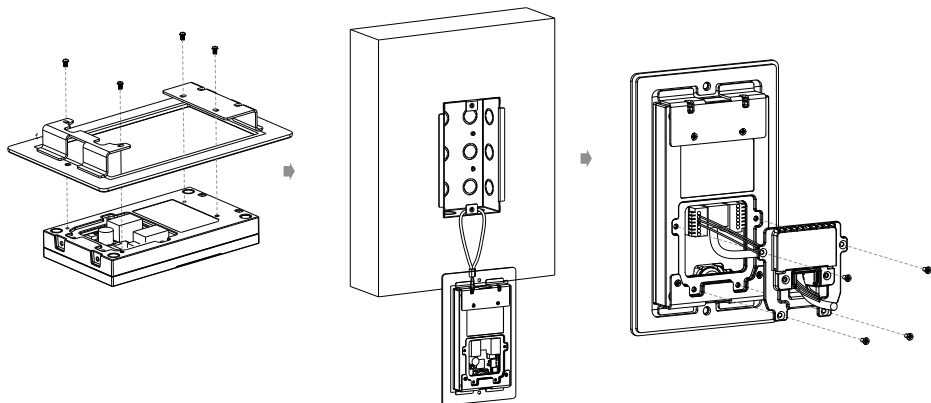

Use four M3x6 crosshead screws to fix R20A on the decorative panel .

For convenient wiring, hang R20A on the Flush-mounting box with rope.

Make cables go through the Wiring cover, connecting to the corresponding interfaces of the main board. Fasten the back cover with four M2.5x6 crosshead screw.

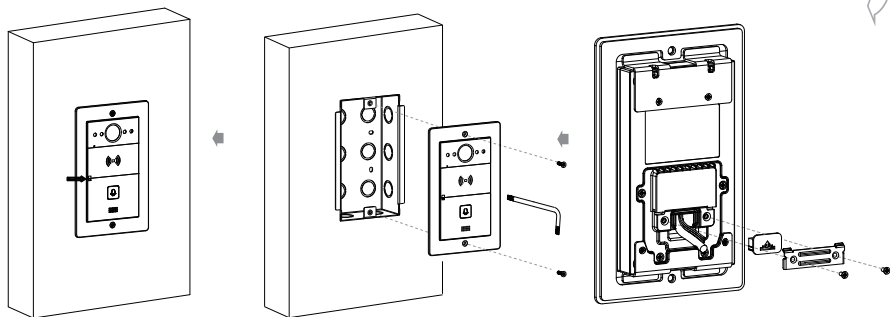

After successful installation, check the stability of device. And remove the protective film.

Place the device into the flush-mounting box, then use L-type spline end wrench to tighten the device with two M4x15 torx head screws.

Select a suitable size rubber plug to push all the cables into the Wiring cover. Fix cable locking plate to the Wiring cover with two M2.5x6 crosshead screw.

Device Wiring

⚠ Warning

When you connect a device containing a coil, such as a relay or an electromagnetic lock, it is necessary to protect the intercom against voltage peak while switching off the induction load. For this way of protection we recommend a diode 1 A / 200 V (included in the accessories) connected antiparallel to the device.

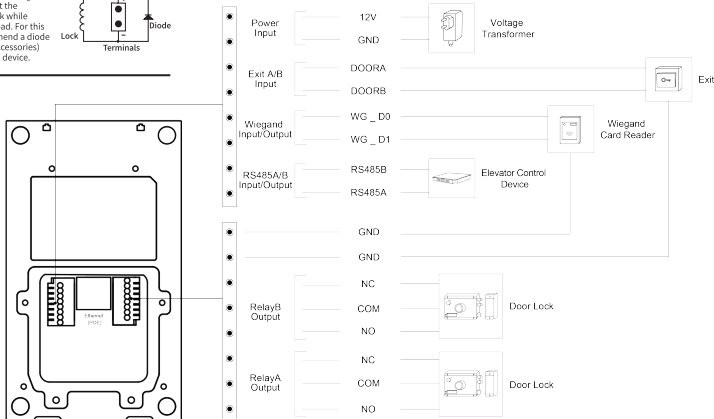
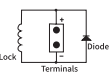

Application Network Topology

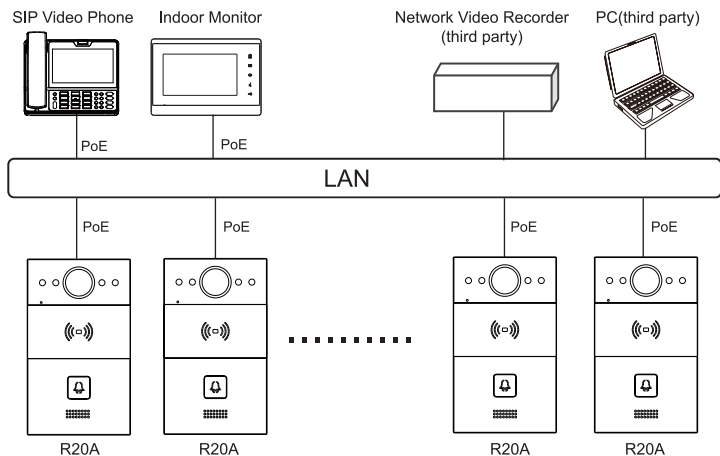

IP Announcement

1. While R20A starts up normally, hold the **Call button** for several seconds after the Status LED turns blue, voice system will enter **IP announcement mode**.
2. In announcement mode, the IP address will be announced periodically.
3. Press **Call button** again to quit the announcement mode.
4. In announcement mode, phone announces "IP 0.0.0.0" if no IP address is gained.

Configuration

1. Access the Web UI: Input the **IP** address into web browser to configure the phone.
2. Account Registration: On web UI, go to the path: **Account > Basic** page to register account and fill in the account information. (*Please refer to admin guide for more information*)
3. Configure the Push Button: On web UI, go to the path: **Intercom > Basic > Push Button** to configure the call number.
4. Configure the code to open the relay: On web UI, go to the path: **Intercom > Relay** -> **Relay ID/DTMF** and choose the DTMF code number in corresponding area.

Operation

Make a call:

Press the **Call button** to call indoor SIP Phone.

Unlock:













During the talk, called party can press pre-configured Unlock key to unlock the door.

Receive a call:

R20A supports Auto Answer by default. Incoming call will be answered automatically.

Indicators

 Light ON  Light OFF

Name	Status	Description
Status indicator	Blue	 Normal status
		 0.25sec →  0.25sec
	Red	 0.05sec →  0.05sec
		 0.25sec →  0.25sec
	Green	 Initialing/Talking on a call
		 0.25sec →  0.25sec
	Red/Blue	 0.05sec →  0.05sec

Note: For more LED settings, please refer to R20A webUI: Intercom -> LED Setting.

Notice Information

Akuvox R20A firmware contains third-party open source software under the terms of the GNU General Public License (GPL). Akuvox is committed to meeting the requirements of the GNU General Public License (GPL) and will make all required source code available.

The source code of software under the terms of GNU GPL can be downloaded online: <http://www.akuvox.com/gpl>.

Information contained in this document is believed to be accurate and reliable at the time of printing. This document is subject to change without notice, any update to this document can be viewed on Akuvox' s website: <http://www.akuvox.com> © Copyright 2022 Akuvox Ltd. All rights reserved.



AKUVOX (XIAMEN) NETWORKS CO., LTD.

ADD: 10/F, NO.56 GUANRI ROAD, SOFTWARE PARK II, XIAMEN 361009, CHINA
www.akuvox.com

