

IP Horn speaker

SIP-S21M



Overview

IP horn speaker SIP-S21M with built-in 30W amplifier is designed to be easily installed for outdoor environments. It is well compatible with SIP & ONVIF protocols that can be used in VoIP and Onvif VMS, also NVR for security fields. Up to 10 RTP multicast addresses enable to arrange different paging solutions. Alarm in and HTTP URL are able to combine with alarm systems. Pre-recorded messages and schedule broadcasting to meet various paging demands.

The 48K OPUS Audio Codec enables excellent sound quality to make announcements, play background music, security alarms in schools, factories and hospitals, etc.

1. Two-Way Intercom Communication.
2. 48K OPUS, AEC, AGC, ANR
3. Compatible with VoIP, SIP devices (IPPBX, IP Phone) via SIP.
4. Compatible with IP Camera VMS via ONVIF.
5. HTTP Control, Alarm in, Schedule
6. 30W Amplifier, PoE Power Supply
7. Built-in MIC, Audio in

Dimension

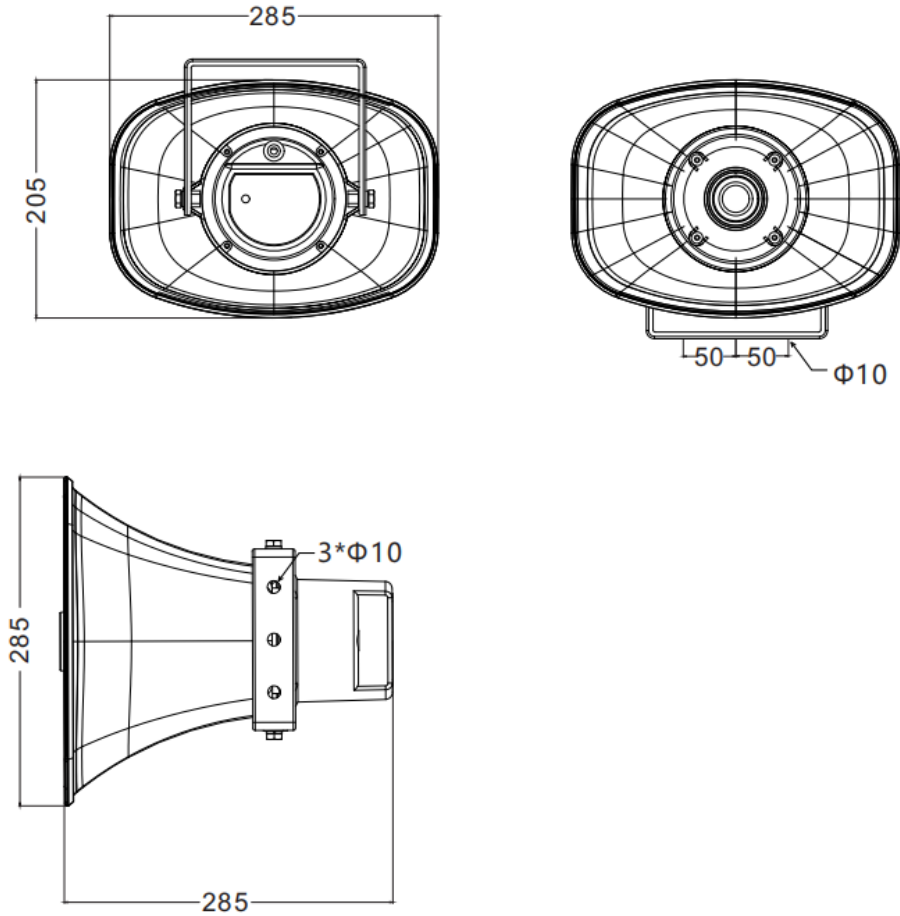

Cable Interface

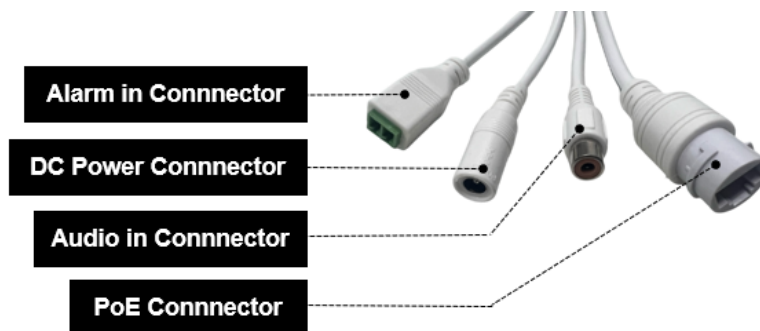

1. Alarm in Connector: Max 3.3V, Prerecorded play, SIP call and Http Stream Enable
2. PoE connector: RJ45
3. DC power Connector: 12-24V
4. Audio in: Top priority of all audio source like RTP multicast, SIP paging.

Specification

Audio	
Codec	OPUS 48KHz, MP3 44.1KHz, G.722 ADPCM 16KHz, G.711U 8KHz, G.711A 8KHz, GSM, LPCM Stereo 44.1KHz, LPCM Mono 44.1KHz
Built-in Microphone	Yes
Speaker	
Max SPL	120dB
Frequency Response	350Hz~8KHz
Frequency Range	500-2KHZ +-10dB 400-12KHZ +-20dB
Harmonic Distortion	0.1@1kHz
Signal to Noise Ratio	91dB
Network	
Security:	Password protection, IP address filtering, Digest authentication, firewall
Network Protocol	SIP, SIP P2P, ONVIF, HTTP, HTTPS, IPv4, DHCP, RTSP, RTP, RTCP, TCP, UDP, ARP, NTP
Network Interface	10/100 Base-TX, RJ45
VoIP	Support for SIP protocol for integration with VoIP systems, integrated with SIP/PBX. 2 SIP Accounts SIP Direct IP Call SIP P2P Codec: OPUS, G.722, G.711U, G.711A
Amplifier	
Amplifier Description	Built-in 30W Amplifier
General	
Operating Temperature	-30°C - +60°C
Storage Temperature	-40°C - +70°C
Operating humidity	5% - 85%
Material	ABS (IP66 water-proof)
Rate Power	30W
PoE	802.3at
Power Supply	DC 12V/3A, 24V/2A
Connector	Alarm in, Audio in, DC Power, PoE

Dimensions	285*205*285mm
Net Weight	2 KG

Software

Date/Time	Local time, NTP
Network	DHCP, Static IP Address
Onvif	Profile S
SIP Account	Support 2 SIP account registration
Audio	<p>Codec: OPUS, G.722, G.711U, G.711A</p> <p>Speaker out: Volume adjustment, Amp auto off setting, Jitter Buffer, HPR and NR adjustment</p> <p>Build in Mic: Volume adjustment, Gain, AEC, AGC, HPR and NR adjustment</p>
Media File	5 embedded belling, 10 customized uploads (free space about 4MByte)
Alarm	Support prerecorded playing, SIP call, Http Stream URL, Http URL
Schedule	10 schedule setting
RTP	10 RTP multicasting
Firewall	Enable to config via IP/MAC, Automatic Defense
Auto Provision	DHCP Option, PnP, Static Provisioning Server (TFTP, FTP, HTTP)
System	Enable for reboot, reset, and FW upgrade, also user account and passcode change

Accessories

1. PoE waterproof connector



2. Quick Guide (Customized or White label)

A5 size, folded in half

IP Speakers Quick Start Guide



15W Ceiling



15W/30W Wall



15W White Horn



30W White Horn



15W Grey Horn



30W Grey Horn

Features

- Compatible with VOIP SIP device.
- Compatible with ONVIF VMS.
- PoE eliminates need for local power supply.
- 48K OPUS Audio Codec enables excellent sound quality.
- Support pre-recorded messages, schedule, HTTP, alarm in.

Specification

Speaker	Ceiling	Wall	Wall	White Horn	White Horn	Grey Horn	Grey Horn
Protocol	SIP, ONVIF, HTTP, IPv6, DHCP, RTP, RTCP, TCP, UDP, ARP, FTP, TFTP, NFS, NTP						
Codec	OPUS 48 kHz, MP3 44.1 kHz, G.722 ADPCM 16 kHz, G.711 PCMU 8 kHz, G.711 PCMA 8 kHz						
Network Interface	RJ45, 10BASE-T/100BASE-TX						
Power	PoE or DC 12V/24V						
Rated Power	15W	15W	30W	15W	30W	15W	30W
Built-in MIC	Optional	N/A	N/A	N/A	Optional	N/A	N/A
Max SPL	96dB	103dB	105dB	113dB	120dB	113dB	120dB
Frequency Response	100Hz-18kHz	80Hz-20kHz	80Hz-20kHz	300Hz-8kHz	350Hz-8kHz	300Hz-8kHz	350Hz-8kHz
Type	Ceiling	Wall	Wall	Horn	Horn	Horn	Horn
Material	Metal	ABS (IP55)	ABS (IP55)	ABS (IP67)	ABS (IP67)	ABS (IP67)	ABS (IP67)
Weight	1KG	3KG	3.75KG	1.4KG	2KG	1.4KG	2KG
Size	200*90 mm	296*196 *157 mm	296*196 *157 mm	225*165 *240 mm	285*205 *290 mm	200*230 mm	246*292 mm

Packing

1. Individual box



310*250*310mm (L*W*H)

2. Outer box (4pcs)

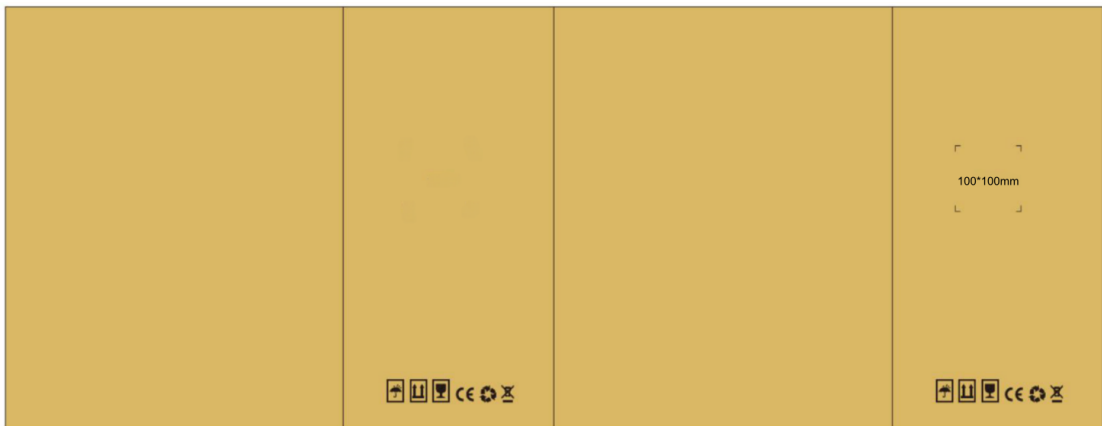

515*320*640mm(L*W*H)